

© OLI - Sistemas Sanitarios, S.A. All rights reserved, also regarding any disposal, exploitation, reproduction, editing, distribution, as well as in the event of applications for industrial property rights.

| General Tolerances DIN 16901-150    |       |       |       |       |       |       |       |       |       |       |
|-------------------------------------|-------|-------|-------|-------|-------|-------|-------|-------|-------|-------|
| Nominal dimension range bis / up to | 0     | 1     | 3     | 6     | 10    | 15    | 22    | 30    | 40    | 53    |
| Not mould-dependent measure         | ±0.23 | ±0.25 | ±0.27 | ±0.30 | ±0.34 | ±0.38 | ±0.43 | ±0.49 | ±0.57 | ±0.68 |
| Mould-dependent measure             | ±0.13 | ±0.15 | ±0.17 | ±0.20 | ±0.24 | ±0.28 | ±0.33 | ±0.39 | ±0.47 | ±0.58 |
| Nominal dimension range bis / up to | 70    | 90    | 120   | 160   | 200   | 250   | 315   | 400   | 500   | 630   |
| Not mould-dependent measure         | ±0.71 | ±0.87 | ±1.10 | ±1.40 | ±1.70 | ±2.10 | ±2.70 | ±3.30 | ±4.20 | ±5.20 |
| Mould-dependent measure             | ±0.60 | ±0.70 | ±0.85 | ±1.05 | ±1.25 | ±1.55 | ±1.90 | ±2.30 | ±2.90 | ±3.60 |

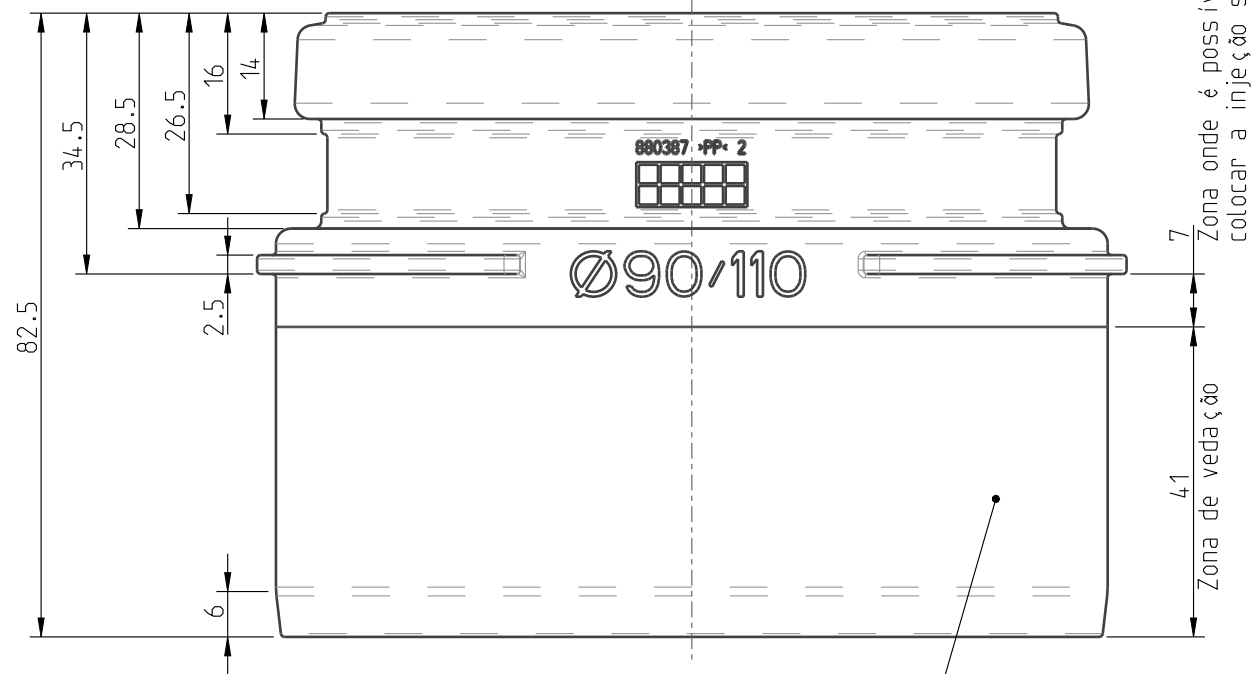
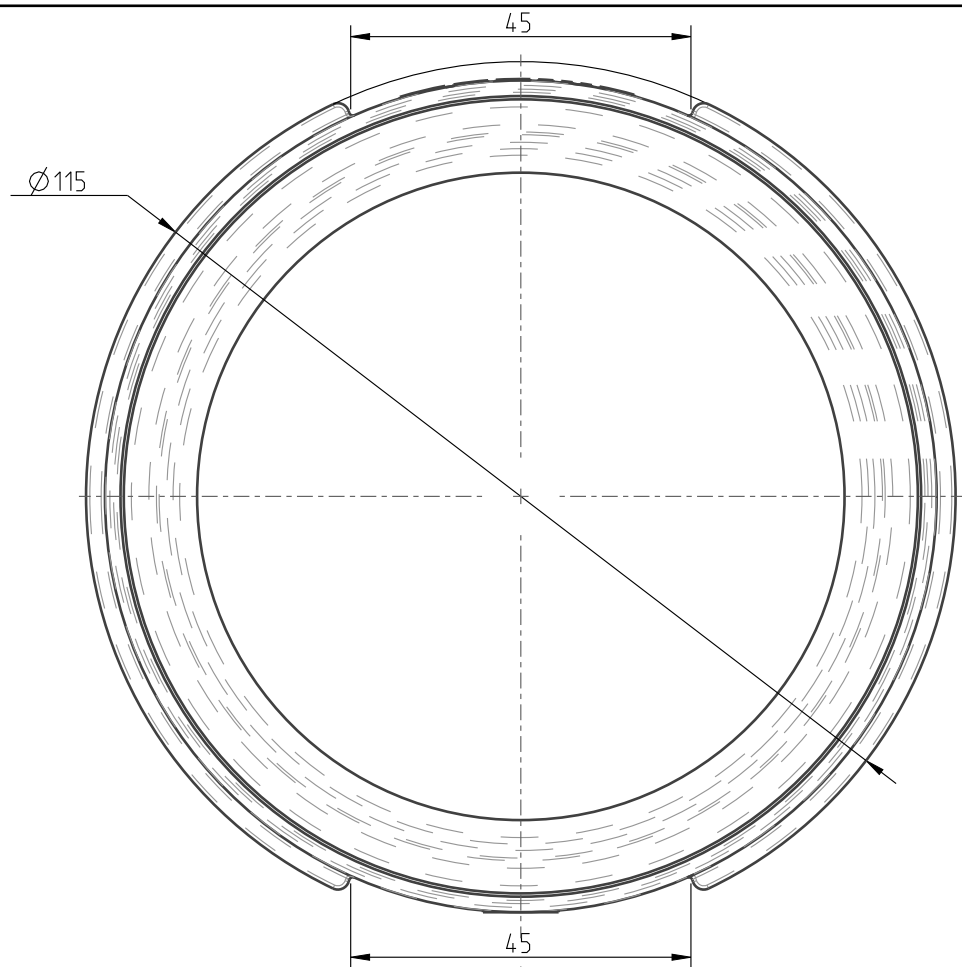

Superfície de vedação

Inclinação de saída nesta superfície sujeita a alteração

Zona onde é possível colocar a injeção submersa

Datador anual - Ø10

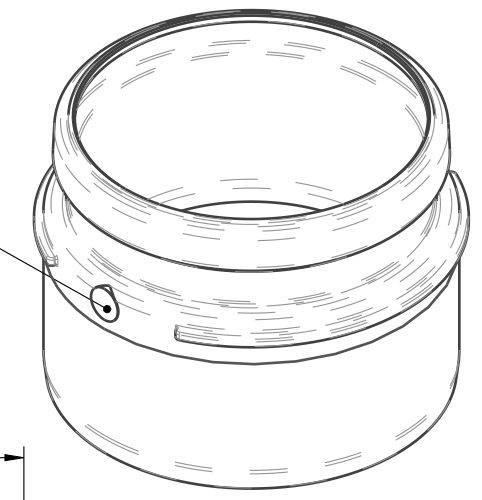

SCALE 1:2

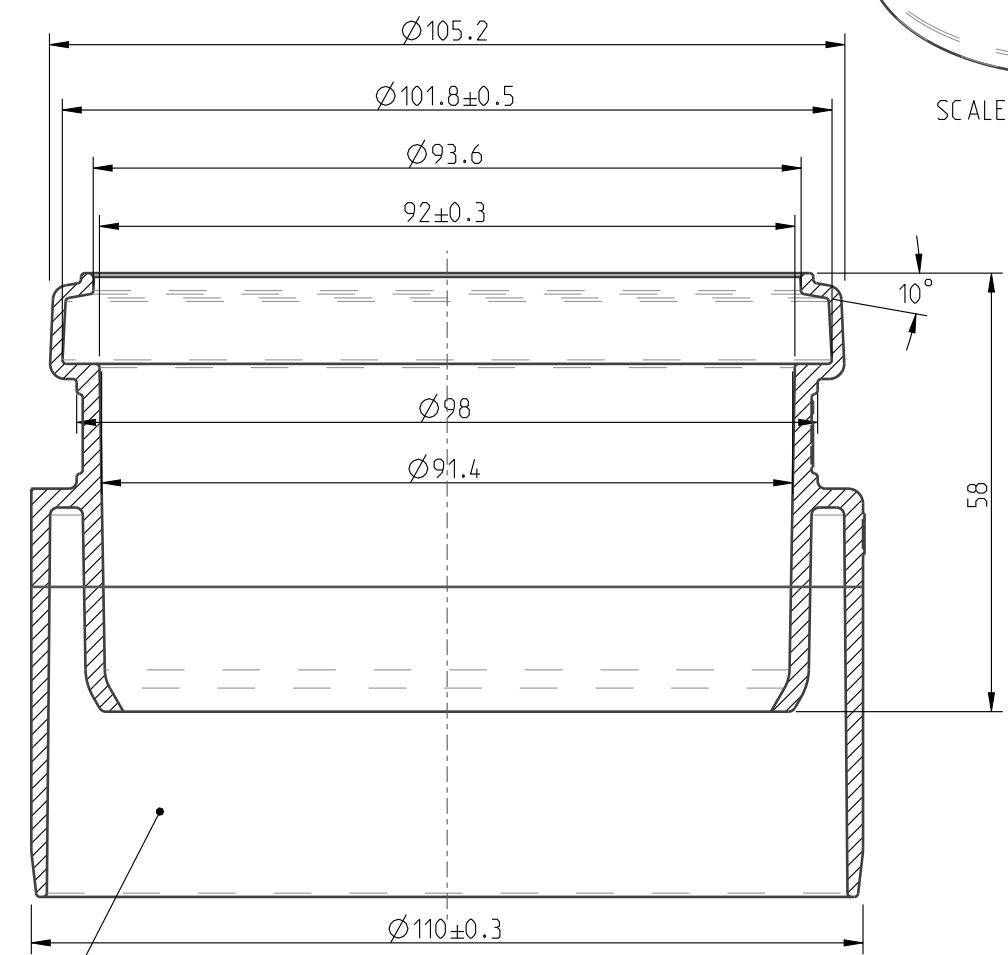

SECTION F-F

Primary geometry completely defined in 3D-model  
Note for injected parts: - Overall Finish Ra 1.6, unless other indications.

Nome/Name: **TUB RED DE 90/110 PRT**



|   |                    |   |
|---|--------------------|---|
| Codigo/Code:<br><b>BA50000880387</b>    |                    | Molde/<br>Mould:<br>N Cav.: <b>1276</b> |
| Rev. nº: <b>19</b>                      | Proj.: <b>3215</b> | Material: <b>PP</b>                     |
| Data/Date: <b>04-Jul-23 06:51:10 PM</b> |                    | Shrinkage: <b>15%</b>                   |
| Peso/Weight (g): <b>81.851</b>          |                    | Volume (mm <sup>3</sup> ):              |
| Folha: <b>1/2</b> Esc: <b>1:1</b>       |                    | <b>90945.304</b>                        |